

x1R Smart Multi-Reader installation guide

ISEO Zero1
ELECTRONIC SOLUTIONS

CE ISEO
EC Declarations of conformity available at:
<https://www.iseo.com/it/en/download>

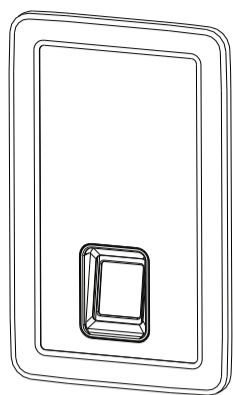

ISEO
iseo.com

Iseo Serrature s.p.a
Via San Girolamo 13
25055 Pisogne (BS)
ITALY
Tel. +39 0364 8821
iseo@iseo.com

ELECTRONIC SUPPORT SERVICE
iseozero1.com



Non contractual document. Subject to change. Cod. 6000098102696 - 20200722
Multi-Reader Installation Guide (EN) - © 2020 Iseo Serrature S.p.a. - www.iseo.com

WARNINGS



- Read this manual prior to use the device in order to ensure a safe and proper use. Preserve this manual as future reference.
- The installation and maintenance of the device must be carried out by qualified technical staff, adequately trained by ISEO.
- The instructions should be carefully followed during installation. These instructions and any maintenance instructions should be passed on by the installer to the user.
- No modifications of any kind are permitted, except for those described in these instructions.
- The product must be destined only for the use for which it is expressly designed and therefore as a reader for residential, commercial and light industry. Any other use is considered improper and dangerous.
- The electrical connection must be made according to the constructor's instructions and respecting the regulations in force.
- Disconnect the power supply before carrying out any technical service that involves opening or accessing the internal parts of the product. For all repairs, exclusively contact a technical assistance center authorized by the constructor.
- Operating and storage temperature: -20°C/+70°C with Relative Humidity Max. 95% without condensing. IP grade: IP66.
- RFID communication technology: 13.56 MHz. Works with Mifare Classic and Mifare DESFire. Minimum keyfob coil diameter 20mm.
- RFID: frequency 13,553 - 13,567 MHz, maximum magnetic field: < 40 µA/m (measured at 10m at the maximum power capacity). Radio: frequency 2,40 - 2,4835 GHz, maximum power: < 10 mW.

1. COMPONENTS

Multi-Reader with fingerprint

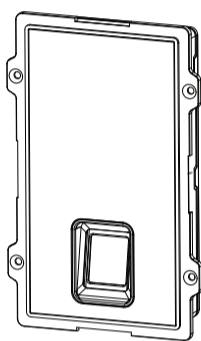

Multi-Reader

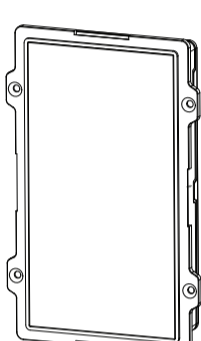

COVER

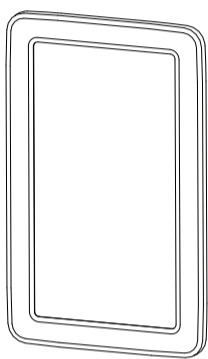

Fixing screws

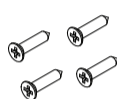

Connection wirings: 3 or 2 cables depending on reader model (cables length 1mt)

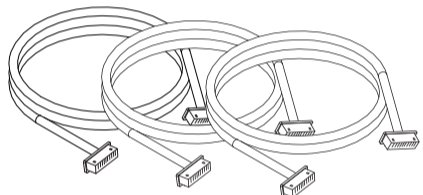

The Multi-Reader can be supplied in two different models: with fingerprint or without it. For more information and codes refer to the commercial literatures and the catalogue.

2. MODELS AND DIMENSIONS

UM = mm

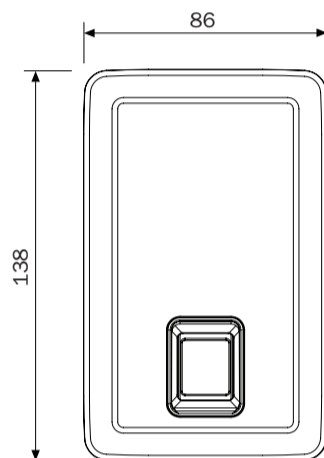

Multi-Reader with fingerprint

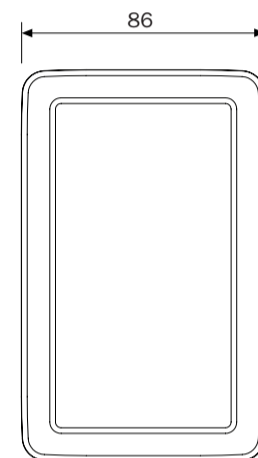

Multi-Reader

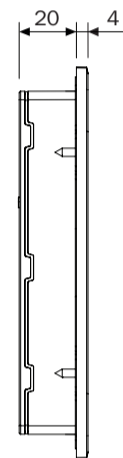

3. INSTALLATION EXAMPLE (Multi-Reader with fingerprint)

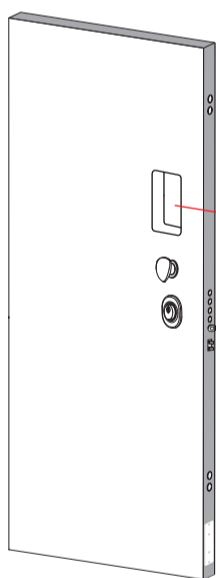

1



Be careful to respect the hole measures in order to leave enough space on the sides to fit the reader fixing screws.

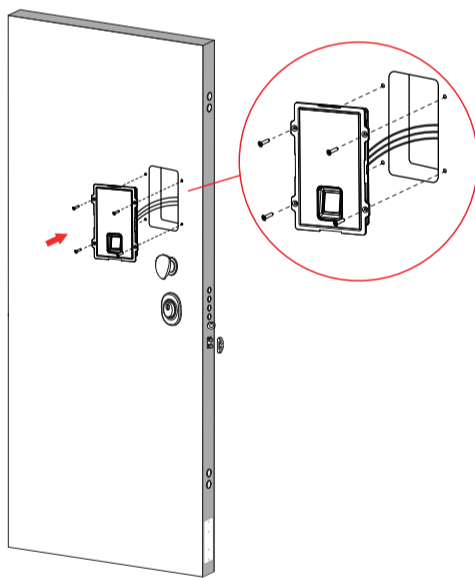

2

3.1 INSTALLATION EXAMPLE (Multi-Reader without fingerprint)

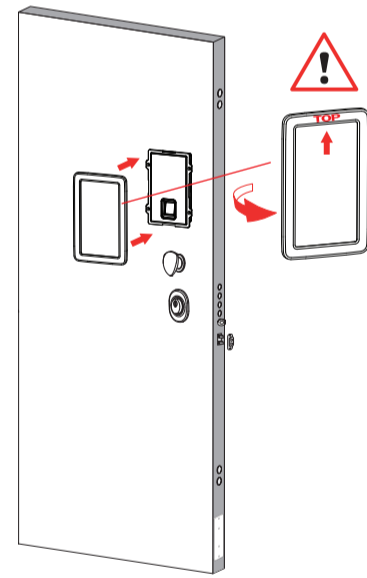

3

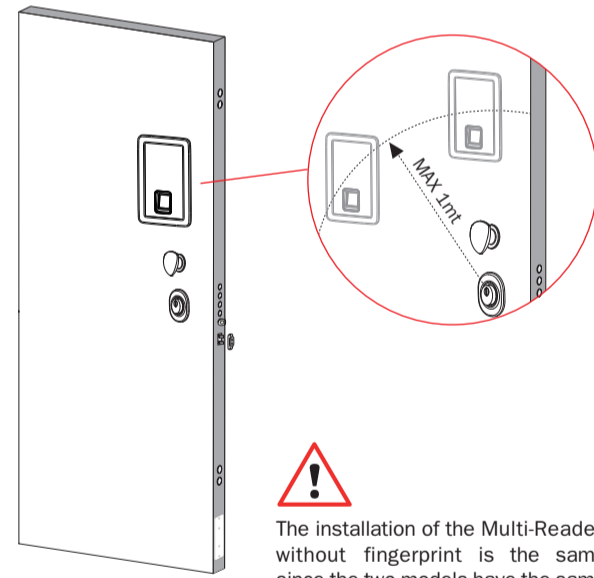

4



The installation of the Multi-Reader without fingerprint is the same since the two models have the same measures and installation way.

4. ELECTRICAL CONNECTION

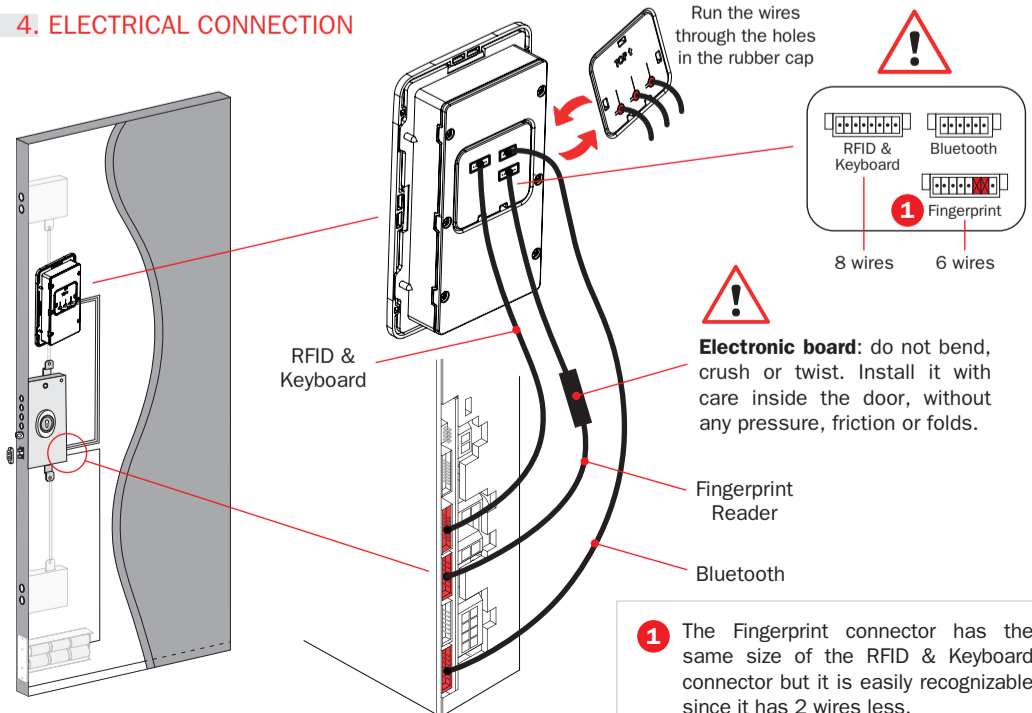

5. MULTI-READER KEYBOARD WAKE-UP

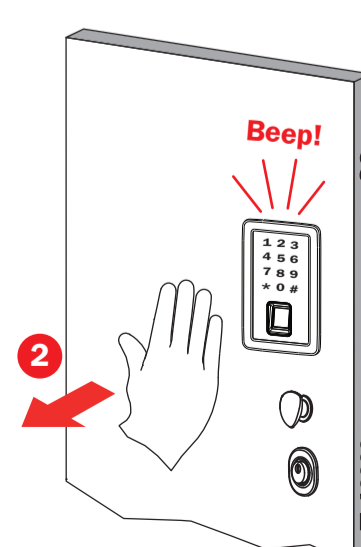
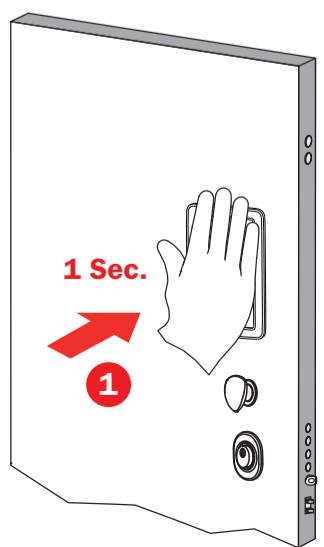

x1R Smart

Multi-Lettore guida installazione

ISEO Zero1
ELECTRONIC SOLUTIONS

 
EC Declarations of conformity available at:
<https://www.iseo.com/it/it/download>

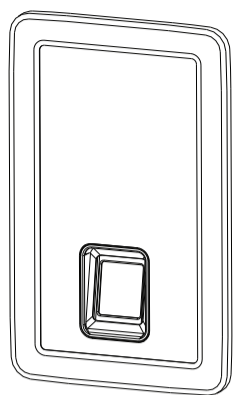

ISEO
iseo.com

Iseo Serrature s.p.a
Via San Girolamo 13
25055 Pisogne (BS)
ITALY
Tel. +39 0364 8821
iseo@iseo.com

ELECTRONIC SUPPORT SERVICE
iseozero1.com



Download

User Manual



app.iseo.com

Documento non contrattuale. Soggetto a modifica. Cod. 6000098102696 - 20200722
Guida Installazione Multi-Lettore (IT) - © 2020 Iseo Serrature S.p.a. - www.iseo.com

AVVERTENZE



- Leggere il manuale utente prima dell'utilizzo del prodotto al fine di garantire un uso sicuro e corretto. Conserva questo manuale come riferimento futuro.
- L'installazione e la manutenzione del prodotto devono essere effettuate da personale tecnico qualificato, adeguatamente addestrato da ISEO.
- Le istruzioni devono essere seguite attentamente durante l'installazione. L'installatore deve fornire all'utente queste istruzioni ed eventuali istruzioni per la manutenzione.
- Nessuna modifica di alcun tipo è consentita, ad eccezione di quelle descritte in queste istruzioni.
- Il prodotto dovrà essere destinato solo all'uso per il quale è stato espressamente concepito e cioè come lettore per ambiente residenziale, commerciale e industria leggera. Ogni altro uso è da considerarsi improprio e pericoloso.
- I collegamenti elettrici devono essere fatti secondo le istruzioni del costruttore e nel rispetto delle normative vigenti.
- Scollegare l'alimentazione prima di eseguire qualsiasi intervento tecnico che comporti l'apertura o l'accesso alle parti interne del prodotto. Per le riparazioni, rivolgersi esclusivamente a un centro di assistenza tecnica autorizzato dal costruttore.
- Temperatura di funzionamento: -20°C/+55°C con Umidità Relativa Max. 90% senza condensa. Grado IP: IP66.
- Tecnologia della comunicazione RFID: 13.56 MHz. Funziona con Mifare Classic e Mifare DESFire. Diametro minimo antenna keyfob 20mm.
- RFID: frequenza 13,553 - 13,567 MHz, massimo campo magnetico: < 40 µA/m (misurato a 10m alla massima potenza erogabile). Radio: frequenza 2,40 - 2,4835 GHz, potenza massima: < 10 mW.

1. COMPONENTI

Multi-Lettore con impronta digitale

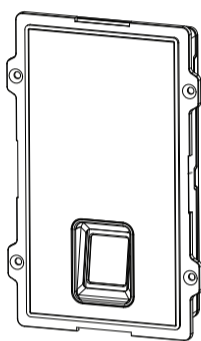

Multi-Lettore

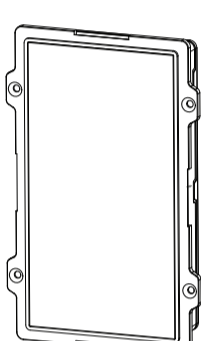

MOSTRINA

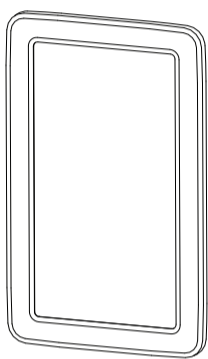

Viti di fissaggio

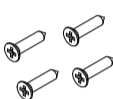

Cablaggio: 3 o 2 cavi a seconda del modello di lettore (lunghezza cavi 1mt)

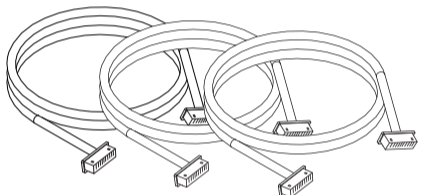

Il Multi-Lettore può essere fornito in due modelli differenti: con lettore di impronte digitali o senza. Per i codici prodotto e per maggiori informazioni consulta il catalogo e la documentazione commerciale.

2. MODELLI E DIMENSIONI

UM = mm

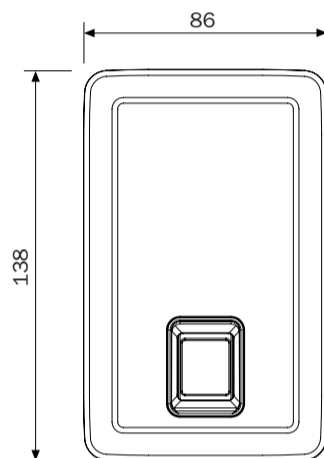

Multi-Lettore con impronta digitale

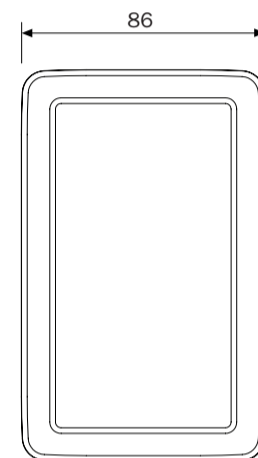

Multi-Lettore

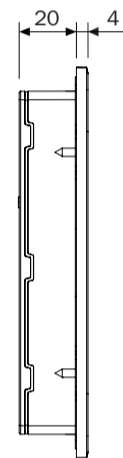

3. ESEMPIO DI INSTALLAZIONE (Multi-Lettore con impronta digitale)

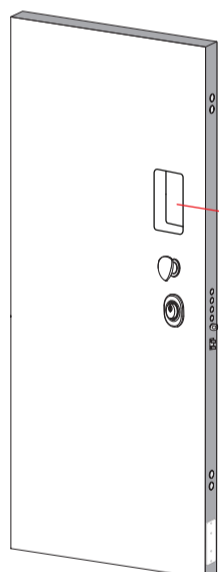

Prestare attenzione a rispettare le misure del foro in modo da lasciare sufficiente spazio ai lati per il fissaggio delle viti del lettore.

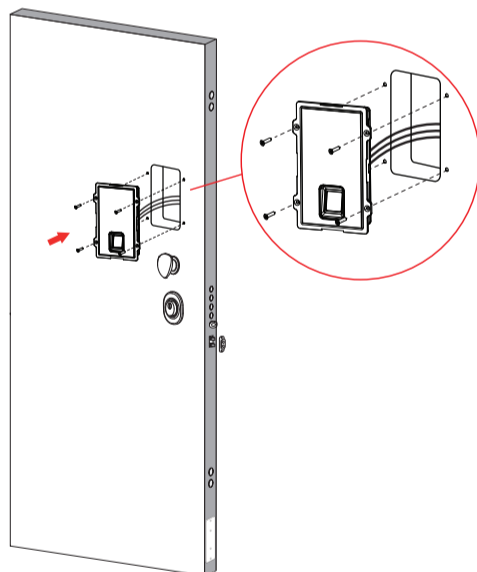

3.1 ESEMPIO DI INSTALLAZIONE (Multi-Lettore con impronta digitale)

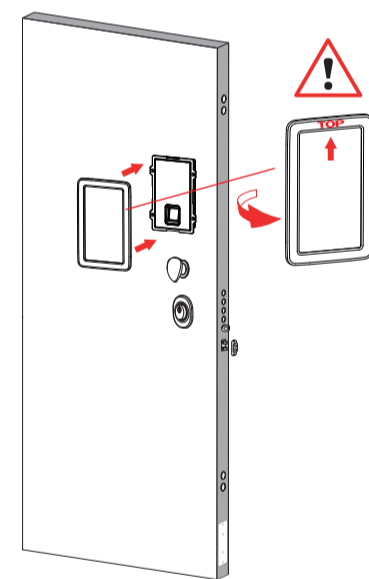

3



4



L'installazione del Multi-Lettore senza impronta digitale è identica perchè i due modelli hanno le stesse misure e lo stesso procedimento di installazione.

4. COLLEGAMENTI ELETTRICI

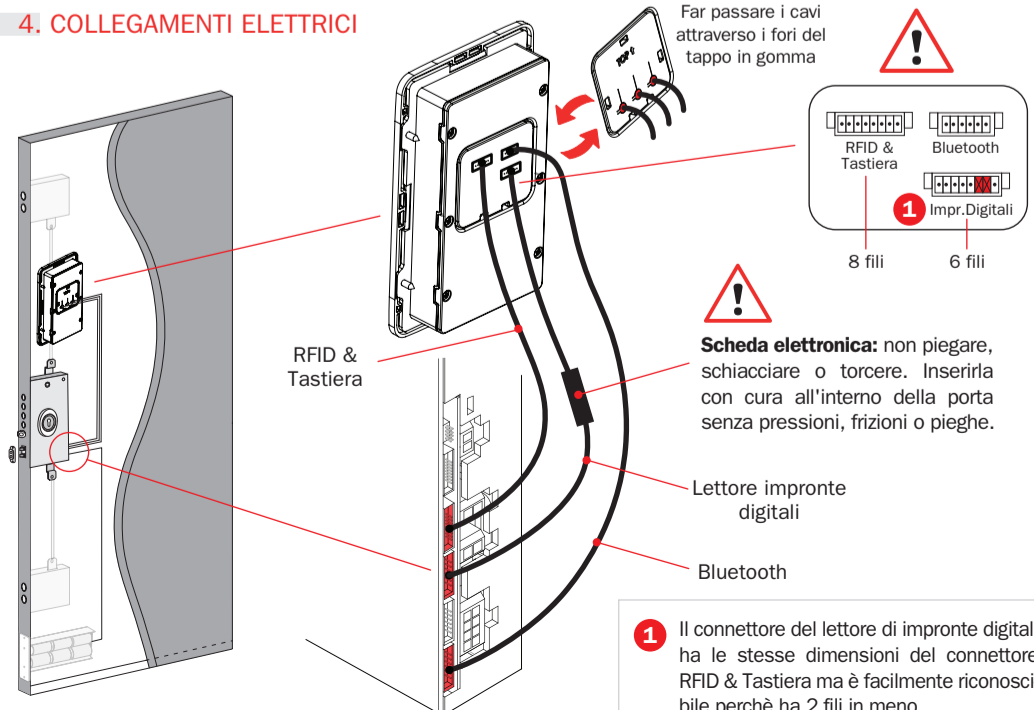

5. ACCENSIONE TASTIERA MULTI-READER

